

# CircLED RB

The CircLED™ RB is a thermally conductive molded polymer high bay or low bay, offering a lighter weight alternative to die cast fixtures, while thermally managing up to a 200 Watt LED Engine. The Remote Box Enclosure separates drivers and controls from the array for better heat dissipation.

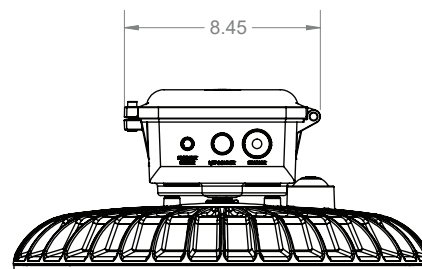
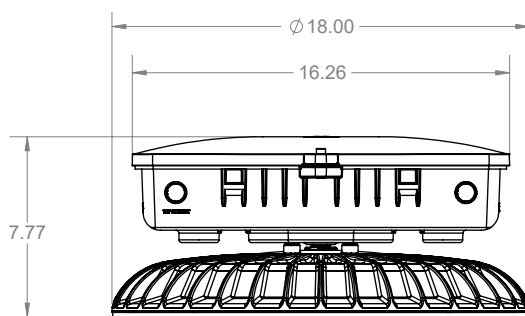
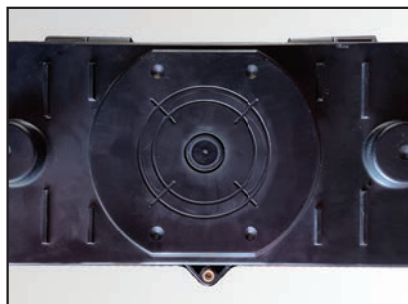

## APPLICATIONS:

- Industrial
- Auditoriums
- Gymnasiums
- Cold Storage
- Warehouse
- Factory
- Exhibition Hall
- Distribution Centers

## CERTIFICATIONS

- UL1598 LISTED
- IP65
- IP66
- NSF

## FEATURES & BENEFITS:

- SLP 5VA Remote Box Enclosure separates drivers from the board to reduce heat
- Remote Box can be mounted to the CircLED from the lid or bottom of the box.
- Designed for LEDs
- Charcoal Black in color so post painting is not needed
- Lightweight Design
- Easy Installation is contractor friendly
- 18" Diameter
- Frosted acrylic lens provides uniform glare-free lighting from the metal core LED array module
- For use with Round LED Module
- Accommodates Occupancy Sensor
- U.S. manufactured CircLED™

Product offering and specifications subject to change without notice.

**CircLED™ Remote Box:**

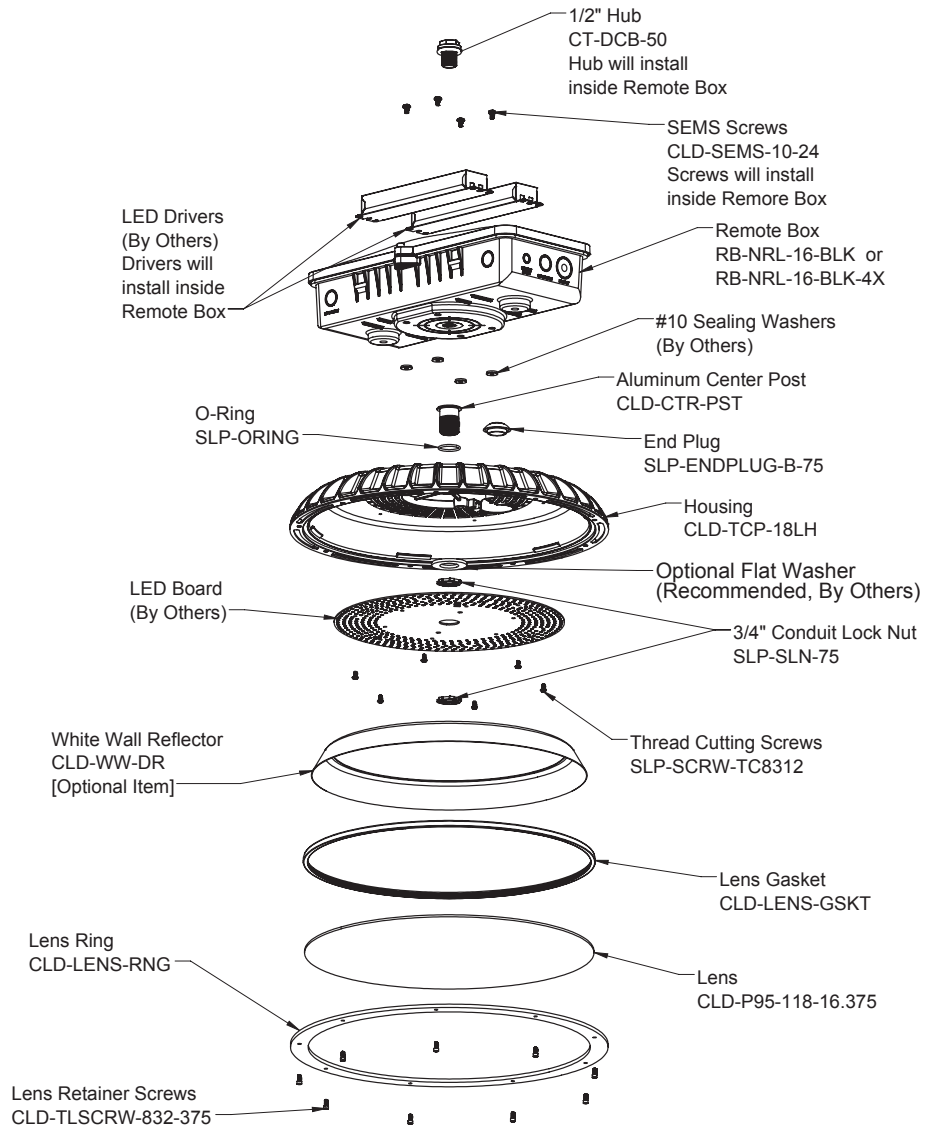
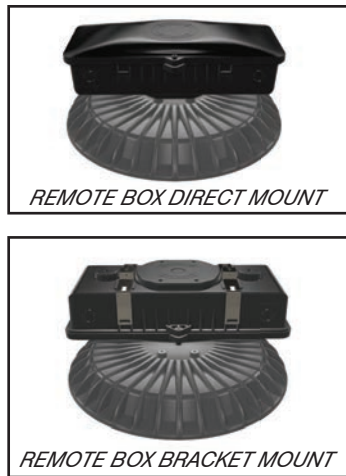

COMPONENT	STANDARD MATERIAL	PIECES REQUIRED PER ASSEMBLY	AVAILABLE OPTIONS
HOUSING	THERMALLY CONDUCTIVE PLASTIC	1	
THREADED CENTER POST	ALUMINUM	1	
O-RING	BUNA-N	1	REQUIRED FOR IP65 & IP66 RATING
CONDUIT LOCKNUT		2	
THREAD CUTTING SCREWS		6	
WHITE WALL REFLECTOR		1	NONE
LENS RETAINER SCREWS		9	
REMOTE BOX	5VA NORYL	1	
SEMS SCREWS		4	
ENDPLUG		1	
DROP LENS REQUIRED PARTS:			
DROP LENS	ACRYLIC OR POLYCARBONATE	1	CLEAR OR FROSTED
DROP LENS GASKET		1	
FLAT LENS REQUIRED PARTS:			
FLAT LENS	ACRYLIC OR POLYCARBONATE	1	CLEAR OR FROSTED
FLAT LENS GASKET		1	
LENS RETAINER RING		1	

Product offering and specifications subject to change without notice.

**CircLED™ Remote Box Components:**

<b>CircLED™ HOUSING EXTRUSIONS</b>						
DIAMETER	DESCRIPTION	PART #	PCS/CTN	WT/CTN	FULL SKID QTY.	
18"	THERMAL CONDUCTIVE PLASTIC HOUSING	CLD-TCP-18LH	10			
<b>CircLED™ LENS &amp; ACCESSORIES</b>						
DESCRIPTION	PART #	PCS/CTN	WT/CTN	FULL SKID QTY.		
DROP LENS FROSTED ACRYLIC	CTR-LENS-18-ACR-FR50					
DROP LENS CLEAR ACRYLIC	CTR-LENS-18-ACR					
FLAT FROSTED ACRYLIC LENS 118 THICK	CLD-P95-118-16.375					
FLAT CLEAR ACRLYIC LENS 118 THICK	CLD-SH-CA-118-16.375					
*POLYCARBONATE LENSES AVAILBLE UPON REQUEST - CONTACT SLP DIRECTLY FOR INFORMATION						
LENS RETAINER RING - THERMAL CONDUCTIVE PLASTIC	CLD-LENS-RNG					
LENS RETAINER SCREW	CLD-TLSCRW-832-375					
DROP LENS GASKET	CLD-DPLENS-GSKT					
FLAT LENS RING GASKET	CLD-LENS-GSKT					
WHITE WALL DIFFUSE REFLECTOR	CLD-WW-DR					
<b>CircLED™ HARDWARE</b>		MATERIAL	PART #	PCS/BAG	PCS/CTN	WT/CTN
THREADED CENTER POST		ALUMINUM	CLD-CTR-PST			
O-RING		BUNA-N	SLP-ORING			
SEMS SCREWS FOR RB ATTACHMENT			CLD-SEMS-10-24			
THREAD CUTTING SCREWS FOR LED ARRAY ATTACHMENT			SLP-SCRW-TC8312			
3/4-14 NPT CONDIT LOCKNUT			SLP-SLN75			
LARGE ENDPLUG			SLP-ENDPLUG-B-75			
<b>CircLED™ MOUNTING</b>		MATERIAL	PART #	PCS/BAG	PCS/CTN	WT/CTN
REMOTE BOX ENCLOSURE		5VA NORYL	RB-NRL-16-BLK			
<b>MOUNTING ACCESSORIES</b>		MATERIAL	PART #	PCS/BAG	PCS/CTN	WT/CTN
MOUNTING BRACKETS FOR REMOTE BOX		316 STAINLESS STEEL	RB-MB-2			
3/4" HUB FOR PENDANT		DIE CAST	CT-DCB-75	100		20LBS/9.07KG
316 STAINLESS STEEL HOOK		316 STAINLESS STEEL	SLP-HOOK-SS-NH75			

Product offering and specifications subject to change without notice.